

# 12-Port Telecom Distribution Module

## Description:

The Telecom Distribution Module is an expansion component used to add additional telephone distribution capability throughout the home or office. This module supports the bridged distribution of any combination of four or fewer analog telephone lines to up to twelve locations.

## Installation: (see Fig. 1)

1. Place the module horizontally.
2. Push the module so the hook and tabs will fall into the rail slots of the enclosure.
3. Slide the module LEFT and the spring fastener will automatically lock the module at the desired position.

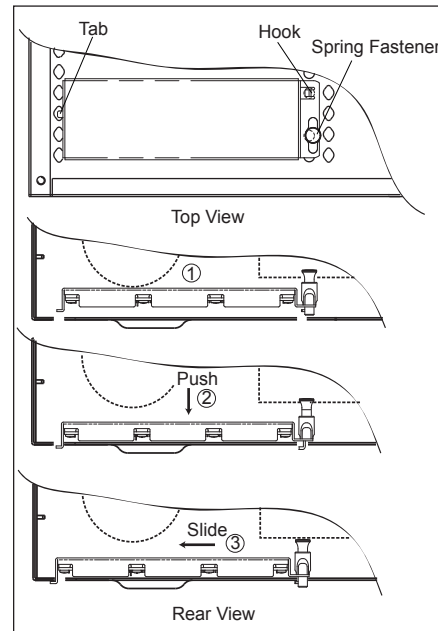

Fig.1

## Operation: (see Fig. 2)

### Connect the incoming phone line

Connect the incoming phone line from telephone company to 110 IDC connector labeled "FROM SOURCE". The connectors are wired in parallel such that the incoming telephone lines will be bridged to all other connectors on this module. Identify twisted pairs coming from each location and route to IDC connectors. Punch down twisted pairs depending on which line is desired to activate at each location. Note - Line#1 = Blue pair, Line#2 = Orange pair, Line#3 = Green pair, Line#4 = Brown pair.

Example: each 110 IDC connector represents one area; if you want to activate line #1 at Location #1, simply punch down the twisted pair (Blue/White Blue) to the first 110 IDC connector. If you want to use a 2-line phone (Line#1 & Line#2) at Location #1, punch down twisted pairs (Blue/White Blue & Orange/White Orange) to the first 110 IDC connector to support 2-line phone. Note - Normally there is only one twisted pair connected to one IDC connector.

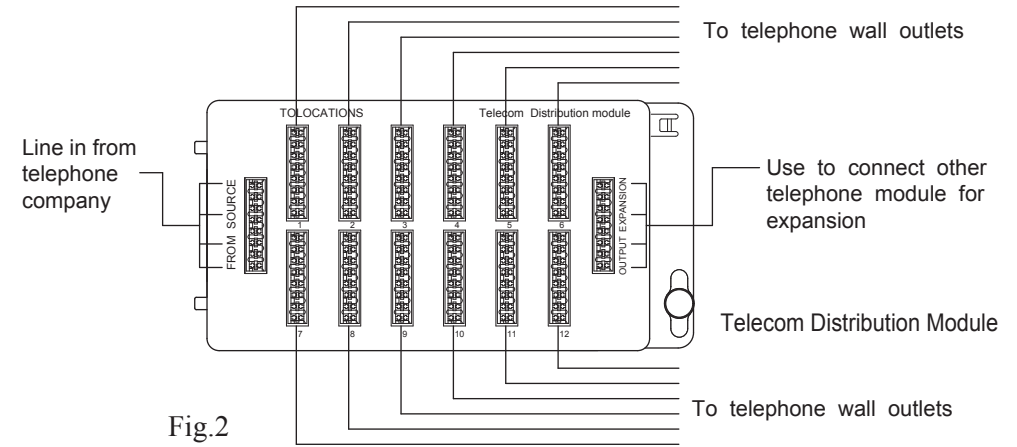

Fig.2

## Wire installation:

For 110 IDC connector, follow the wire color-code and only use the 110 punch-down tool to push the wire between the contact blades (see Fig. 3). For RJ45 plug, follow the TIA T568A standard for wiring instruction (see Fig. 4).

### RJ-45 Jacks

Phone and data lines are wired according to the TIA T568A standard

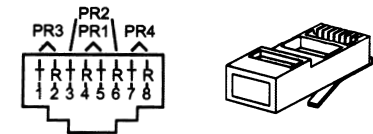

### Wiring a 110 connector

1. Strip 2" of cable jacket.
2. Untwist about 0.5" wire and keep jack close to 110 connector.
3. According to the color code, only use a 110 punch down tool to push the wire between the contact blades. Or wire may be damaged when using other tools.

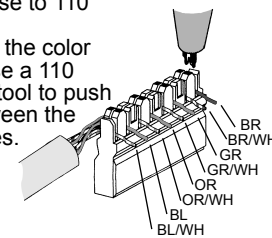

Fig.3

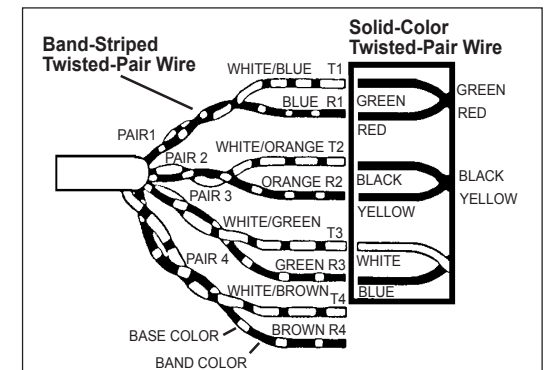

Fig.4