

# Video Distribution Module

## Description:

The Video Distribution Module is designed for whole house video distribution system. It amplifies CATV signal plus two modulator inputs and distributes all channels to eight locations. The Bi-directional traffic with a 5-42MHz return path is perfect for interactive or pay-per-view TV.

## Installation: (see Fig. 1)

1. Place the module horizontally.
2. Push the module so the hook and tabs will fall into the rail slots of the enclosure.
3. Slide the module LEFT and the spring fastener will automatically lock the module at the desired position.

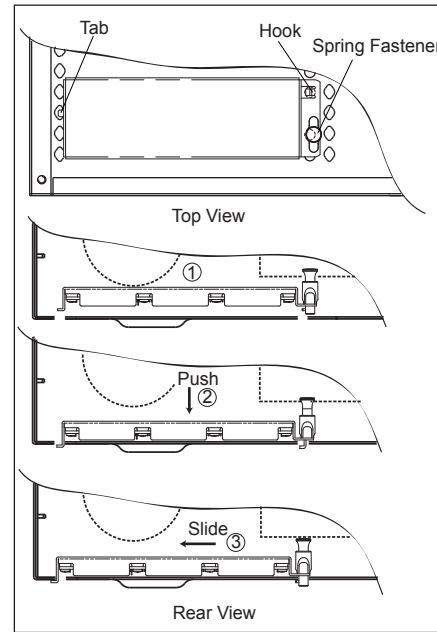

Fig.1

## Operation: (see Fig. 2)

Connect the incoming CATV signal to port labeled "CATV INPUT". The generated modulator signal such as DVD, VCR or cameras can be fit into port labeled "A" or "B". All channels will be combined and distributed to eight locations. Any TV from those eight locations can view any channels without conflicts. A power adapter is included or a DC Power module (Not included) is recommended to provide more protections, stable and save much space if many other adapters applied. Please refer to the following diagram.

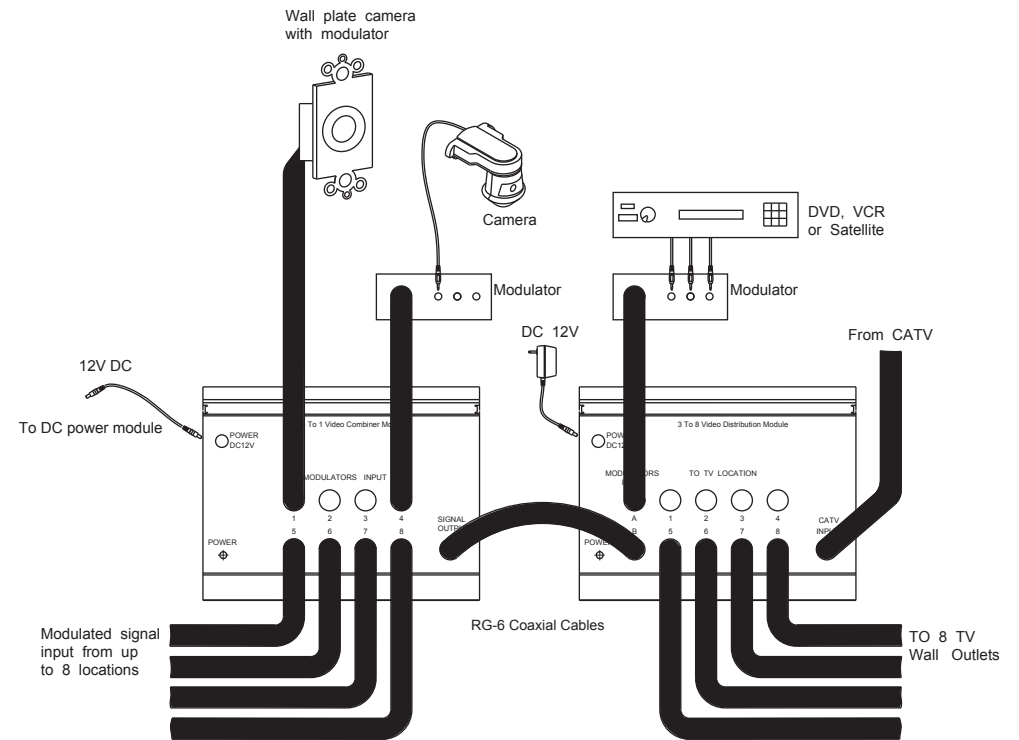

Fig.2